

Overview

Parcel Number

0014742

Tax Year

2026 ▼

Class

R - RESIDENTIAL

Physical Address

31 Melvin Clark Rd Siler City NC 27344

Acreage

2.0000

Market Value

183,952

Exemption/Exclusion

87,976

Deferred

0

Assessed Value

183,952

Tax Rate

Unavailable

Total Tax

Unavailable

No Tax Disbursements

Photos & Sketches

Converted Sketch

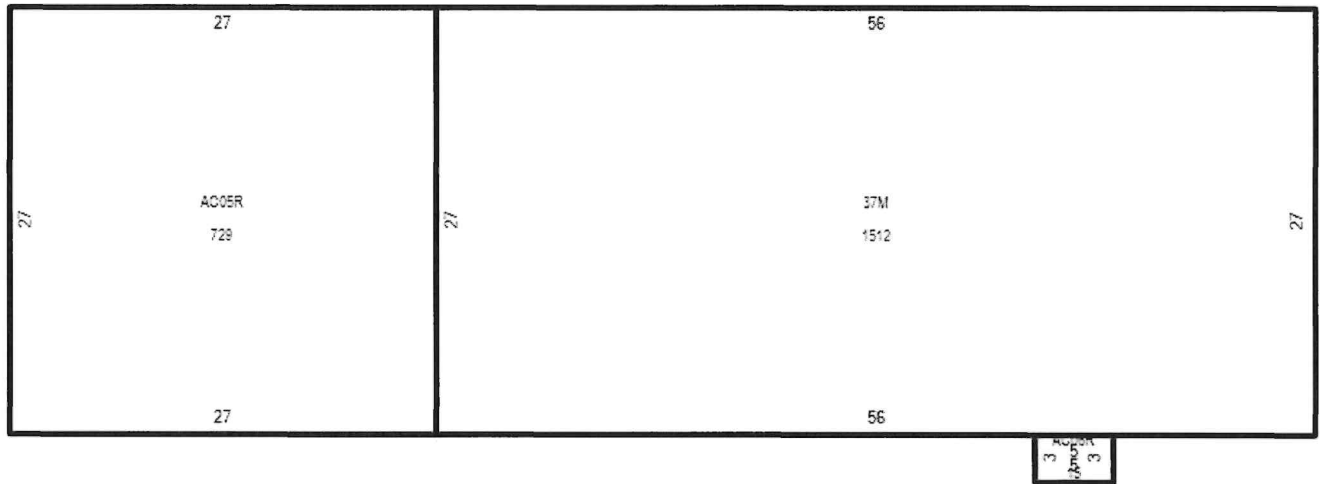

No Billing Details

Tax Amounts Due

	If paid in...	Amount due is...
March 2026		\$0.00
April 2026		\$0.00
May 2026		\$0.00
June 2026		\$0.00
July 2026		\$0.00
August 2026		\$0.00
September 2026		\$0.00
October 2026		\$0.00
November 2026		\$0.00
December 2026		\$0.00

Tax Due amounts are for all unpaid years.

See Payment History section for year-by-year details.

[Pay Taxes](#)

Payment History

Tax Year	Total Due	Total Paid	Amount Unpaid	Date Paid
2025	\$800.04	\$800.04	\$0.00	9/22/2025
2024	\$628.58	\$628.58	\$0.00	12/30/2024
2023	\$603.85	\$603.85	\$0.00	8/7/2023
2022	\$579.48	\$579.48	\$0.00	12/7/2022
2021	\$579.48	\$579.48	\$0.00	8/11/2021

[Show 5 More \(25\)](#)

Zoning

Code	Classification
R-1	RESIDENTIAL DISTRICT 1
R-1	RESIDENTIAL DISTRICT 1

Legal

Legal Description	Subdivision Name	Block	Lot	Plat Book	Plat Page
2.00 ACRE TRACT					

No Exclusions

Owner Information

OWNER

PORTER, ALAN GREGORY

Mailing Address

1039 BONLEE BENNETT RD
SILER CITY, NC 273449681

OWNER

DIXON, CYNTHIA P

Mailing Address

PO BOX 433
SILER CITY, NC 273440433

Transfer History

Book & Page	Sale Type	Sale Date	Sold By	Sold To	Price
2386 0622	NAME CHANGE	9/18/2025	PORTER, FRANCES J LIFE ESTATE	PORTER, ALAN GREGORY DIXON, CYNTHIA P	\$0
2386 0622	WARRANTY DEED	10/23/2023	PORTER FRANCES T	PORTER, FRANCES J LIFE ESTATE PORTER, ALAN GREGORY DIXON, CYNTHIA P	\$0
274 0125	NAME CHANGE	1/28/2017	PORTER WILBUR J	PORTER FRANCES T	\$0
274 0125		12/31/1996		PORTER WILBUR J, PORTER FRANCES T	\$0

No Genealogy

Land Value

Property Class	Valued Acres	Appraised Value
Acre - Residual	1.0000	8,000
Acre - Primary	1.0000	24,000

CAMA - Structure (1 or 2) - Real Estate

Property Class	Description	Total Finished Area	Year Built
RES - Residential	RANCH	1,512	1962
Garages/Carports			
AC05R - Carport			729 Square Ft.
House Type			
20 - RANCH			
Exterior Wall			
EW01 - Brick			100 Percent
Plumbing			
PL02 - Number of Fixtures			-3.00
Base Cost			
37M - Masonry - Main Floor			1,512 Square Ft.
Porches/Decks			
AC06R - Covered Porch			15 Square Ft.
Accommodations			
Number of Bathrooms			2.00
Number of Bedrooms			3.00
Number of Half Bathrooms			0.00
Number of Rooms			7.00
Fireplace			
FP04R - One Fireplace (Non-Prefab)			1.00
Heating & Cooling			
HC07 - Packaged Heat/Cool			1,512 Square Ft.

CAMA - Structure (2 or 2) - Real Estate

Property Class	Description	Total Finished Area
RES - Residential	Outbuildings Only - RES	0
Shed		
MS17R - Implement Shed 3 Side		484 Square Ft. Year Built: 1962
Storage		
MS28R - Storage Bldg. Unfinished		112 Square Ft. Year Built: 1963
MS28R - Storage Bldg. Unfinished		264 Square Ft. Year Built: 1962

Market Value

Year	Market Land	Market Building	Market Total
2026	32,000	151,952	183,952
2025	32,000	151,952	183,952
2024	24,500	1,228	25,728
2023	24,500	1,228	25,728

Map [View Full Screen](#)

Overview

Parcel Number

0014748

Tax Year

2026 ▼

Class

R - RESIDENTIAL

Physical Address

Melvin Clark Rd Siler City NC 27344

Acreage

0.6300

Market Value

4,536

Exemption/Exclusion

0

Deferred

0

Assessed Value

4,536

Tax Rate

Unavailable

Total Tax

Unavailable

No Tax Disbursements

No Photos or Sketches

No Billing Details

Tax Amounts Due

	If paid in...	Amount due is...
March 2026		\$0.00
April 2026		\$0.00
May 2026		\$0.00
June 2026		\$0.00
July 2026		\$0.00
August 2026		\$0.00
September 2026		\$0.00
October 2026		\$0.00
November 2026		\$0.00
December 2026		\$0.00

Tax Due amounts are for all unpaid years.

See Payment History section for year-by-year details.

Pay Taxes

Payment History

Tax Year	Total Due	Total Paid	Amount Unpaid	Date Paid
2025	\$30.39	\$30.39	\$0.00	9/22/2025
2024	\$20.28	\$20.28	\$0.00	12/30/2024
2023	\$19.26	\$19.26	\$0.00	9/27/2023
2022	\$18.75	\$18.75	\$0.00	12/7/2022
2021	\$18.75	\$18.75	\$0.00	11/4/2021

Show 5 More (25)

Zoning

Code	Classification
R-1	RESIDENTIAL DISTRICT 1

Legal

Legal Description	Subdivision Name	Block	Lot	Plat Book	Plat Page
0.63 ACRE TRACT					

No Exclusions

Owner Information

OWNER

DIXON, CYNTHIA P

Mailing Address

PO BOX 433

SILER CITY, NC 273440433

OWNER

PORTER, ALAN GREGORY

Mailing Address

1039 BONLEE BENNETT RD

SILER CITY, NC 273449681

Transfer History

Book & Page	Sale Type	Sale Date	Sold By	Sold To	Price
2386 0622	NAME CHANGE	9/18/2025	PORTER, FRANCES J LIFE ESTATE	PORTER, ALAN GREGORY DIXON, CYNTHIA P	\$0
2386 0622	WARRANTY DEED	10/23/2023	PORTER FRANCES T	PORTER, FRANCES J LIFE ESTATE PORTER, ALAN GREGORY DIXON, CYNTHIA P	\$0
422 0301	NAME CHANGE	1/28/2017	PORTER WILBUR J	PORTER FRANCES T	\$0
422 0301		12/31/1996		PORTER WILBUR J, PORTER FRANCES T	\$0

No Genealogy

Land Value

Property Class	Valued Acres	Appraised Value
Acre - Residual	0.6300	4,536

No CAMA

Market Value

Year	Market Land	Market Building	Market Total
2026	4,536	0	4,536
2025	4,536	0	4,536
2024	2,551	0	2,551
2023	2,551	0	2,551

Map

[View Full Screen](#)